

MIGZONE ENDURANCE SERIES

# MZ-E 505W

**MIGZONE®**  
TORCHES100  
%ED0,8  
-  
1,6  
mm500  
A<sub>CO2</sub>  
450  
A<sub>MIX</sub>**i** 20% more water volume

20% more water volume in the torch neck than the standard MZ-E 400W/500W.

**i** Neck Variations

You can get our whole MZ-E series MIG Torches with rotating necks.

**Complete Torch**

MZ-E 505W cpl. with grey handle,  
Euro-connection (Steel Liner 2,0x4,5mm)

3m	<b>MZ-505WAA3E</b>
4m	<b>MZ-505WAA4E</b>
5m	<b>MZ-505WAA5E</b>

## MIGZONE MZ-E Series – air and watercooled MIG-Torch

**DIN Norm**

Technical data according to CE EN 60 974-7

**The Handle**

2-component handle - robust and ergonomic

**The Trigger**

U/D Module ( Option )

**The Gun and Cable**

Premium components installed

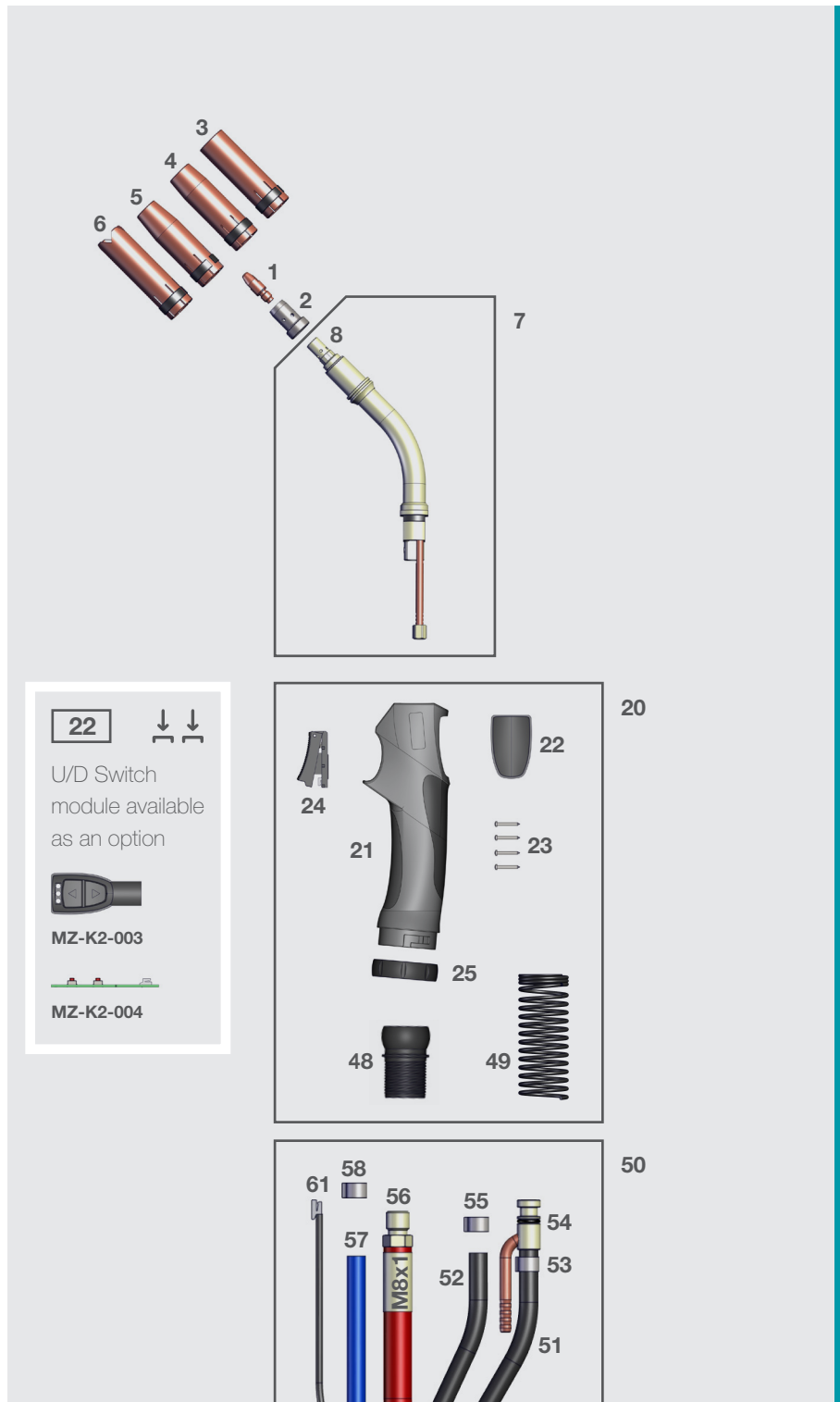

**Complete Torch**

MZ-E 505W cpl. with grey handle, Euro-connection (Steel Liner 2,0x4,0mm)

3m	<b>MZ-505WAA3E</b>
4m	<b>MZ-505WAA4E</b>
5m	<b>MZ-505WAA5E</b>

**Torch Front Group**

1 Contact Tip Pro	M6x28	M8x30
ECu	<b>22506xx</b>	<b>24106xx</b>
CuCrZr	<b>22576xx</b>	<b>24176xx</b>
for Alu	<b>22566xx</b>	<b>24166xx</b>
Contact Tip Eco	M6x28	M8x30
ECu	<b>22506xxL</b>	<b>24106xxL</b>
CuCrZr	<b>22576xxL</b>	<b>24176xxL</b>

**i** Tips available in Ø 0,8/0,9/1,0/1,2/1,4/1,6 mm  
Please insert wire diameter at **xx**.  
Example Ø **1,0** mm is: 10; Art.-No.: = 2410610

2 Gas Diffuser		
white*		<b>2410702</b>
black		<b>2410700</b>
eco		<b>2410702L</b>
Gas Nozzle L=76mm		
3 cylinder NW19		<b>2410801</b>
4 conical NW16*		<b>2410802</b>
5 tapered NW14		<b>2410803</b>
6 Spot Welding NW20		<b>2410805</b>
7 Swan Neck		
MZ-E 505W, complete		<b>505WM100</b>
8 Tip Adapter	M6	M8
short L=25mm	<b>2410406</b>	<b>2410408</b>
long L=29mm	<b>2410416</b>	<b>2410418</b>

**Handle Group**

20 MIG-Handle MZ-K2, grey complete, watercooled		<b>MZ-HDL-K2G-W</b>
21 MIG-Handle MZ-K2, grey left + right half		<b>MZ-K2-001</b>
22 Neutral top MZ-K2		<b>MZ-K2-002</b>
23 Screw for Handle		<b>MZ-K2-005</b>
24 Trigger cpl. MZ-K2		<b>MZ-K2-006</b>
25 Nut for Handle MZ-K2		<b>MZ-K2-007</b>

**Cable Group**

48 Gun Plug Housing Swivel		<b>MZ-K2-008</b>
49 Spring Cable Support		<b>MZ-K2-010</b>
Single Ear Clamp		
53 D = 11,8		<b>11.8GER</b>
55 D = 8,7		<b>08.7GER</b>
58 D = 10,0		<b>10.0GER</b>
52 Gas Hose Ø 4,0x1,5 (PU=100m)		<b>0550111</b>
54 Connector Wire-Gas		<b>21201027</b>
57 Water Hose blue Ø 5,0x1,5, (PU=200m)		<b>CR05/8 BL</b>

**22** U/D Switch module available as an option

**MZ-K2-003**

**MZ-K2-004**

**Cable Group**

Part	3m	4m	5m
50 Cable Assembly MZ-E cpl.	<b>24139M30</b>	<b>24139M40</b>	<b>24139M50</b>
51 Outer Liner MZ-E cpl.	<b>25146M30</b>	<b>25146M40</b>	<b>25146M50</b>
56 Power Cable cpl.	<b>2414130</b>	<b>2414140</b>	<b>2414150</b>
61 Control Cable MZ-E cpl.	<b>24144M30</b>	<b>24144M40</b>	<b>24144M50</b>

**\*** Parts marked with \* are included in the standard configuration

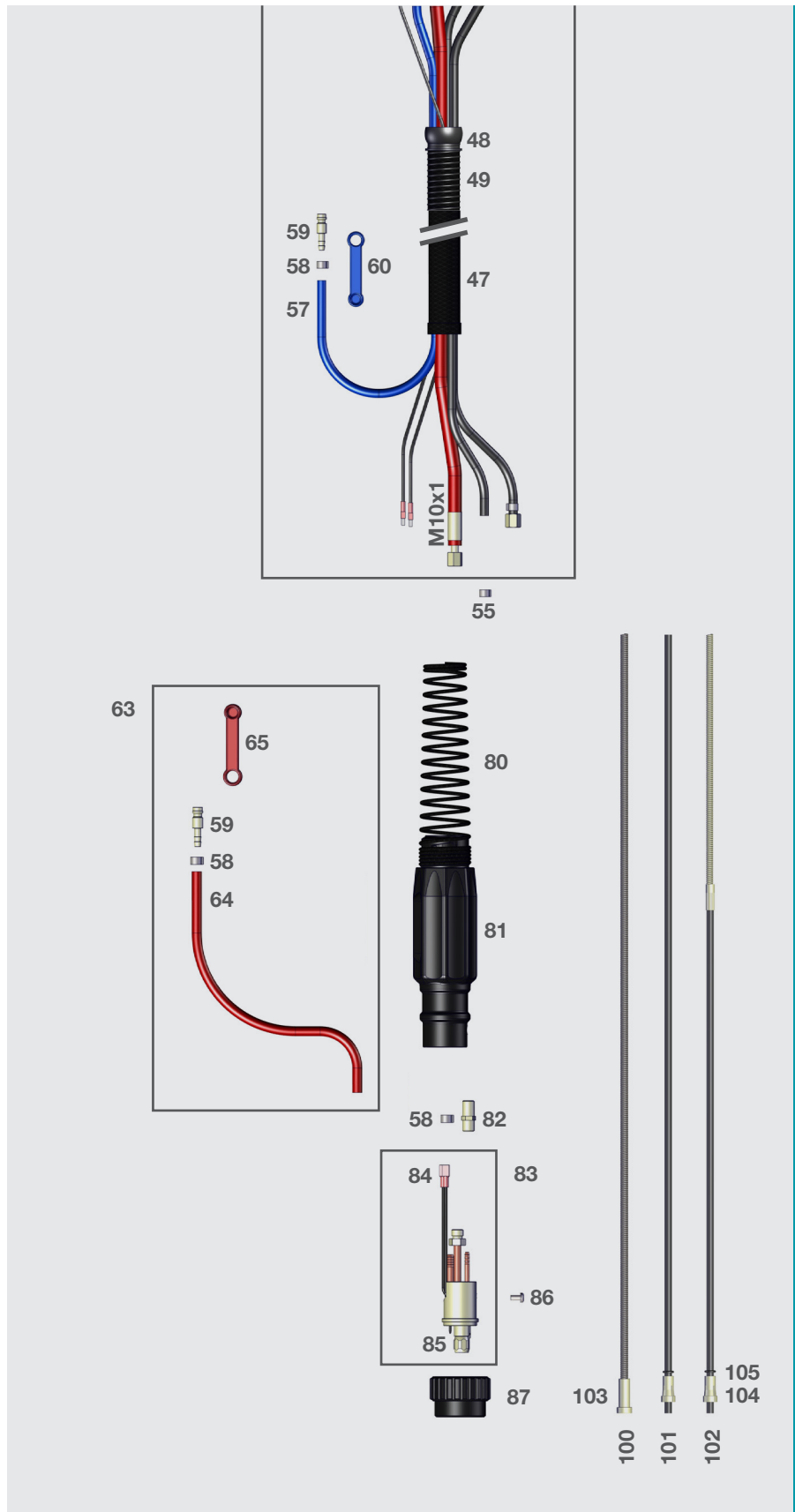

**Cable Group**

47	Cover Hose MZ-E (PU=40m)	WS-2
48	Gun Plug Housing Swivel	MZ-K2-008
49	Spring Cable Support	MZ-K2-010
	Single Ear Clamp	
53	D = 11,8	11.8GER
55	D = 8,7	08.7GER
58	D = 10,0	10.0GER
59	Water Hose Nipple	T0535
	Water Stop	
60	blue	TZ-KAPPE-1
65	red	TZ-KAPPE-2
63	Water Outlet Hose cpl. 0,55m	2414705
64	Water Hose red Ø 5,0x1,5 (PU=200m)	CR05/8 RO
80	Cable Support Spring	2411611
81	Plug Housing without nut	2411600S1
82	Nipple Threaded	2411501
83	Gun Plug Body with Spring Loaded Pins	2411505
84	Female Electrical Connector insulated	2155100
	Nut	
85	Liner Positioner	2151501
87	Plug	ZA-14
86	Screw for Gun Plug Body	ZA-11

**Liner Group 5**

100	Mono-Steel-Liner	
	2,0 x 4,5 mm / X m*	34520X1
	2,5 x 4,5 mm / X m	34525X1
101	Mono-Synthetic-Liner	
	PTFE 2,0 x 4,0 mm / X m red	34120X0
	PTFE 2,7 x 4,7 mm / X m yellow	34727X0
	Carbon-PTFE 2,0 x 4,0 mm / X m	35120X0
	Carbon-PTFE 2,7 x 4,7 mm / X m	35727X0
	PA 2,0 x 4,0 mm / X m	35220X0
	PA 2,3 x 4,7 mm / X m	35323X0
	PA 2,7 x 4,7 mm / X m	35327X0
102	Combi-Synthetic-Liner	
	PTFE 2,0 x 4,0 mm / X m red	34120X0K
	PTFE 2,7 x 4,7 mm / X m yellow	34727X0K
	Carbon-PTFE 2,0 x 4,0 mm / X m	35120X0K
	Carbon-PTFE 2,7 x 4,7 mm / X m	35727X0K
	PA 2,0 x 4,0 mm / X m	35320X0K
	PA 2,3 x 4,7 mm / X m	35323X0K
	PA 2,7 x 4,7 mm / X m	35327X0K

**i** Liners available in 3 m / 4 m / 5 m length. Please insert length at X. Example: Steel-Liner 4 m = 3452041

**\*** Parts marked with \* are included in the standard configuration

	Collet (Mono & Combi)	
103	for Steel-Liner Ø 4,5 mm	2155645
104	for Synthetic-Liner Ø 4,0 mm	2155740
104	for Synthetic-Liner Ø 4,7 mm	2415747
105	O-Ring for Synthetic and Combi Liner	0031500